

# Plat of Survey

of

## Lot 1 of Certified Survey Map No. 4601,

recorded in Vol. 30 of Certified Survey Maps of Walworth County on Page 152 and located in Government Lot 2 and the Northeast 1/4 of Section 36, Town 4 North, Range 16 East, Town of LaGrange, Walworth County, Wisconsin.

Surveyed for: **Jack & Nancy Sorenson**  
3910 Raintree Lane  
Northbrook, Illinois. 60062

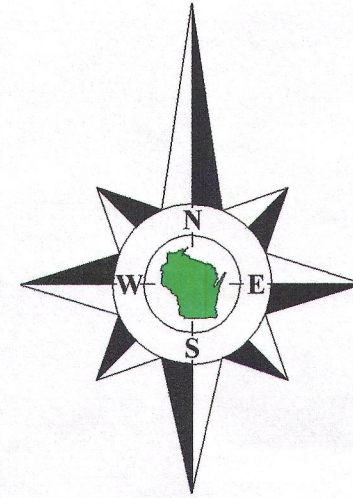

Bearings reference to the Wisconsin State Plane Coordinate System, South Zone.

Witness Corner  
Section 36-4-16  
N. 281.721.57  
E. 2.386.976.43

Center 1/4 Corner  
Section 36-4-16  
N. 281.787.39  
E. 2.388.358.92

N87°16'27"E 1384.13'  
North line of the Southwest 1/4 of Section 36-4-16.

Lot 1  
C.S.M. 4363

Mill

Lake

**Lot 1**  
**Tax Parcel**  
**HA460100001**  
0.667 Acre  
29,067 Sq.Ft.

**Poured  
Concrete  
Foundation**

**Country Club Drive**  
(33' Wide)

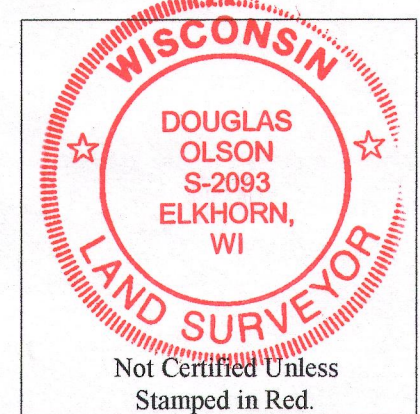
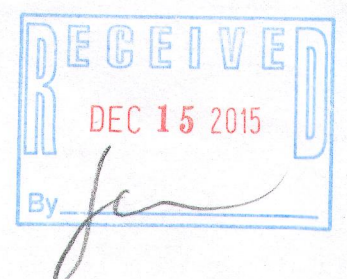

### Notes:

- 1) This survey plat is not certified unless signed and sealed in red ink.
- 2) This survey is subject to Wisconsin lien laws. This Plat of Survey is the notice of intent to file lien. Lien waiver required.

Copyright 2015 by Olson Land Surveying, LLC.

All rights reserved. No part of this survey plat may be reproduced or transmitted in any form by any means - graphic, electronic, or mechanical, including photocopying, tracing, or information storage and retrieval systems - without permission in writing from Douglas G. Olson, Olson Land Surveying, LLC.

I, Douglas G. Olson, Wisconsin Professional Land Surveyor, do hereby certify that this survey was performed by me, or under my direction in full compliance with the owner's/agent's instructions and Chapter A-E 7 of the Wisconsin Administrative Code "Minimum Standards for Property Surveys"; and that this map is an accurate representation thereof to the best of my knowledge and belief.

Douglas G. Olson  
Wisconsin Professional Land Surveyor - 2093

Sheet 1 of 1 Sheets

Drawing Name:

Job Reference Number

### Legend

- Found Iron Pipe
- Found Iron Rod
- Recorded Information
- Concrete Cover
- Utility Pole
- Vent



**Olson Land Surveying, LLC**

45 South Wisconsin Street \* P.O. Box 322 \* Elkhorn, Wisconsin. 53121  
Telephone: (262) 723-3434 \* Facsimile: (262) 723-8044

Scale in Feet  
1" = 20'

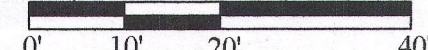

Survey Date: November 18, 2015.  
Revisions: